

Formaldehyde Gas Sensor

Product Data Sheet
Model #SS21F8

2023. Ver 1.0

Applications

- Environmental monitoring of formaldehyde
- Ideal for portable instrument
- Indoor air monitoring applications
- Etc.



Specifications

| Performance Characteristics | |
|------------------------------------|---------------------------------|
| Output Signal | 200±50 nA / ppm |
| Typical Baseline Range (pure air) | ≤±0.05 ppm |
| T90 Response Time | <30 seconds |
| Measurement Range | 0-10 ppm |
| Maximum Overload | 20 ppm |
| Linearity | Linear |
| Repeatability | ≤±3% |
| Recommended Load Resistor | 10 ohms |
| Resolution (Electronics Dependent) | ≤0.01 ppm typical |
| Environmental | |
| Temperature Range Continuous | -10°C to +40°C |
| Pressure Range | 800 to 1200 mbar |
| Operating Humidity Range | 15% to 90% Rh |
| Life Time | |
| Long Term Output Drift | ≤10% per annum |
| Recommended Storage Temp | 0°C to 20°C |
| Expected Operating Life | ≥24 months in air |
| Standard Warranty | 24 months from date of dispatch |
| Intrinsic Safety Data | |
| Maximum at 20ppm | 0.3mA |
| Maximum o/c Voltage | <1.3V |
| Maximum s/c Current | <1.0A |

Dimension

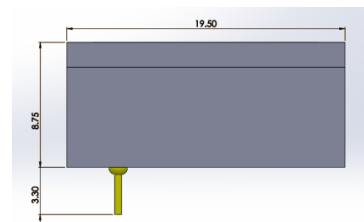

Due to ongoing research and product improvement, specifications are subject to change without notice

Temperature effects

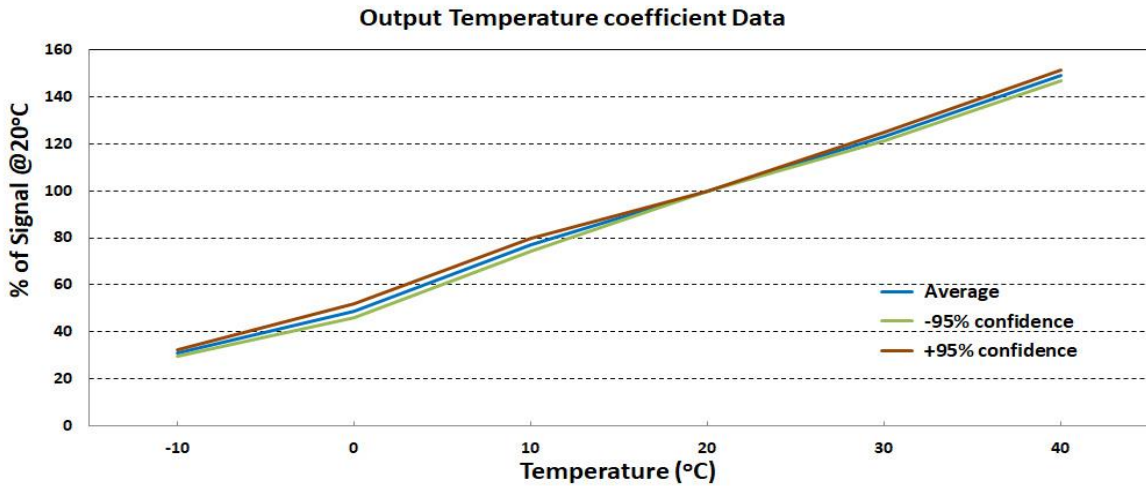

Cross sensitivity

| Substance | Cross Sensitivity (%) |
|-----------------|-----------------------|
| Ammonia | 0 |
| Carbon monoxide | 2 |
| Ethanol | ≤32 |
| Acetaldehyde | 14 |
| Toluene | 4 |
| Acetic acid | 0 |

Standard operating circuit

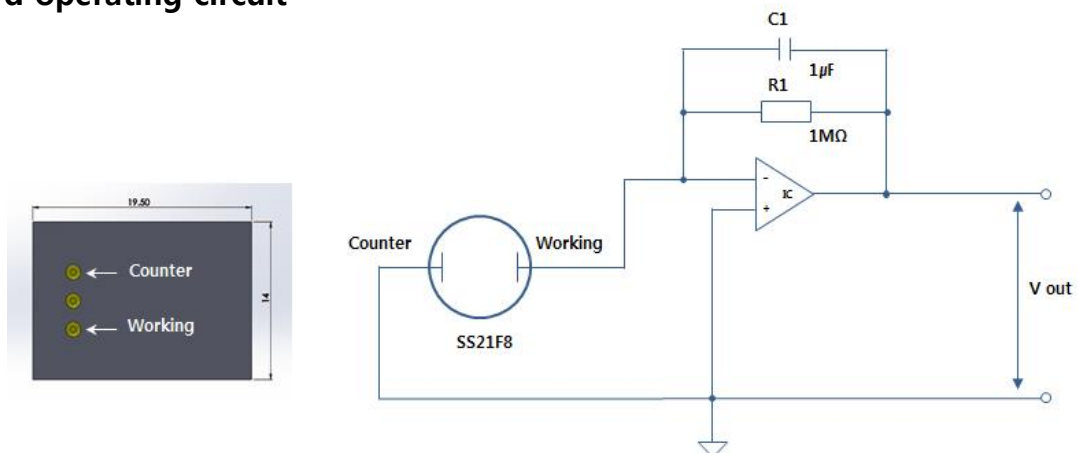

Due to ongoing research and product improvement, specifications are subject to change without notice